

AXiA ES

PEDESTRIAN STACKERS

1.0 – 1.6 tonnes

TIGHTER MOVEMENT... FOR MAXIMUM STORAGE

The compact AXiA ES stacker range has the shortest chassis on the market, allowing it to work in extremely narrow aisles so you can get the most out of your storage space.

SPECIFICATIONS

SBP10N2	SBP16N2	SBP16N2R
SBP12N2	SBP16N2I	SBP16N2IR
SBP12N2I	SBP12N2R	SBP16N2S
SBP12PC	SBP12N2IR	SBP16N2SR
SBP14N2	SBP14N2R	
SBP14N2I	SBP14N2IR	



**WHEN
RELIABILITY IS
EVERYTHING...**

AXiA ES

SBP10-16N2/12PC Series

PEDESTRIAN STACKERS

1.0 – 1.6 tonnes

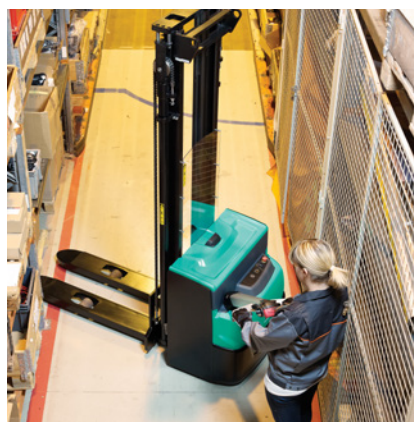

Unaffected by dirt, debris, dust and water thanks to its sealed protective chassis and waterproof components (rated to IP54*), the AXiA ES will work dependably indoors or out with minimum maintenance.

Designed for safety and efficiency the AXiA ES has an exceptionally large foldable platform so that the operator has space to adjust position without stepping off the truck.**

AXiA ES offers two operating modes. ECO mode is suitable for new operators as it limits speed for smooth movement. PRO mode supports faster speeds for optimum performance and productivity.***

Controls are located on both the left and right sides of the ergonomic tiller arm, making the truck safer and easier to operate.

For operation on ramps and uneven floors, initial lift (i) models are the best choice. A straddle leg version is available for handling bottom-boarded pallets up to a width of 1200 mm. Foldable platforms for occasional ride-on use are available on the 1.2 to 1.6 tonne stackers.

FRAME AND BODY

- **Low centre of gravity**
Operation is safer and more stable.
- **High-visibility**
Operator has a good view of the fork tips and working area.*
- **Low to the ground**
Ground clearance is only 20mm so there is no risk of foot trapping.
- **Operate in low temperatures**
Can be used for cold storage applications in temperatures as low as 1°C with sealed components impervious to condensation.*

- **Sealed chassis**
Internal components are protected against water, dirt, dust and debris, reducing downtime and servicing.***
- **Water-resistant design**
Water is kept away from key electrical parts for safety and longer part life.***

OPERATOR COMPARTMENT AND CONTROLS

- **Choice of two pre-set operating modes (ECO and PRO)*****
Enabled via key switch to enhance safety, energy efficiency and productivity.
- **PIN-code access**
Stops unauthorised truck use and keeps you aware of who's operating at all times.**
- **Easy-to-operate tiller arm**
Its large buttons mean operators can focus on the task in hand and minimise mistakes.
- **Left-handed or right-handed controls**
The tiller arm's versatile design allows for operation from either side.
- **Micro-computer**
Includes hour meter, battery indicator and cut out.*

FORKS AND MAST

- **Robust forks**
Strong welded construction with rounded tips for effortless pallet entry.
- **Tapered forks**
Access to pallets in racks or block stacks is easier, quicker and safer.

DRIVE

- **Powerful AC drive motor**
Excellent traction and ramp performance, smooth, quiet, controlled operation, extended shift length and lower maintenance requirements.

- **Sealed transmission**
Shock-resistant, quiet and requires little maintenance.***

BRAKES

- **Parking brake**
Automatically activated when necessary for extra safety on ramps.

STEERING SYSTEM

- **Small turning circle**
Combine this with the compact chassis and operation is possible in tight areas allowing for optimised use of warehouse space.

ELECTRICAL AND CONTROL SYSTEMS

- **Programmable controller**
Acceleration, speed and braking can be adjusted to suit the application and operator's preferences.
- **Battery discharge indicator**
Fitted as standard for battery protection and preventing deep discharge.
- **Battery rollers**
Changing batteries is quicker, easier and safer.
- **Li-ion battery**
Fast charging - removing the need for extra batteries. (Optional)*

OTHER FEATURES

- **RapidAccess features**
These allow quick and easy entry to all areas for checks and maintenance.



There is more information on AXiA ES on mitforklift.com

For more extensive information please visit our website mitforklift.com



Continuing improvement may lead to changes in these specifications.

*Only available on SBP12PC. **Only available on R models. ***Not available on SBP12PC.

mft2.eu/axiaes



AXIA ES

OPTIONAL LI-ION BATTERY SYSTEMS FOR THE SBP12PC MODEL

MAKE YOUR FORKLIFT (AND ITS FUEL) GO EVEN FURTHER

Tried, tested and proven in the field, lead-acid batteries have been the long-standing top choice for companies employing electric lift trucks. However, with long charging times, demanding maintenance requirements, the need for extra batteries and high risk of operator misuse, it can be a challenge. Fortunately, there's a new battery system on the block: Li-ion from Mitsubishi Forklift Trucks.

Designed to meet your business' demands - including multi-shift (24/7) operations - without the need for spare batteries, our high-performance Li-ion battery system is up to 40% more efficient than lead-acid counterparts. Plus, it's virtually error-proof, thanks to its ultra-low-maintenance design which prevent cell damage.

- **Exceptional, zero-emissions efficiency** 40% more efficient than lead-acid batteries and free from gases.
- **Ultra-low maintenance design** demands just a full charge each week to activate cell balancing, as well as an annual CSV export/update.
- **No space required** With no need for charging areas, there's no cost for set up and you can keep your profitable space just that: profitable..
- **Quick charge capabilities** mean that just 15 minutes is all your battery needs to keep your truck going a few more hours. (It only takes 1 to 2 hours to fully charge a completely discharged battery.)
- **Higher sustained voltage** ensures more consistent lifting and driving performance, which is particularly noticeable towards the end of a shift.
- **TriCOM Technology** delivers exceptionally high system efficiency (up to 97%).
- **Water-free design** With no water in the battery and no need to top up, there's no risk of operators damaging cells.
- **Active protection componentry** This continuously monitors the system, highlighting potential issues, including misuse.
- **Short circuit protection** is offered by system safeguards including: deep-discharge and overcharge protection, individual cell temperature and voltage monitoring.
- **On-the-go performance and monitoring** is possible thanks to the system's integrated monitoring system with easy-to-read display unit, as well as an opportunity charger on board.



SBP12PC LI-ION BATTERY AND CHARGER

Battery capacity, Ah	104
Charger capacity, Ah 1 hour	25

There is more information
on Li-ion
on mitforklift.com

For more extensive information
please visit our website
mitforklift.com



mft2.eu/ion

VDI - PERFORMANCE & DIMENSIONS

CHARACTERISTICS				Mitsubishi Forklift Trucks	Mitsubishi Forklift Trucks	Mitsubishi Forklift Trucks	Mitsubishi Forklift Trucks	Mitsubishi Forklift Trucks
1.1	Manufacturer			SBP12PC	SBP10N2	SBP12N2	SBP14N2	SBP16N2
1.2	Manufacturer's model designation			Battery	Battery	Battery	Battery	Battery
1.3	Power source			Pedestrian	Pedestrian	Pedestrian	Pedestrian	Pedestrian
1.4	Operator type							
1.5	Load capacity	Q	kg	1250	1000	1200	1400	1600
1.6	Load center distance	c	mm	600	600	600	600	600
1.8	Load wheel axle to fork face (forks lowered)	x	mm	950	625	625	625	625
1.9	Wheelbase	y	mm	1473	1141	1205	1205	1205
WEIGHT								
2.1	Truck weight without load, with maximum battery weight		kg	775	820	1205	1220	1225
2.2	Axle loadings with nominal load & maximum battery weight, drive / load side		kg	875 / 1150	740 / 1080	830 / 1575	835 / 1785	835 / 1990
2.3	Axle loadings without load & with maximum battery weight, drive / load side		kg	575 / 200	605 / 215	820 / 385	825 / 395	825 / 400
WHEELS, DRIVE TRAIN								
3.1	Tyres: PT = Power Thane, Vul = Vulkollan, P = Polyurethane, N = Nylon, R = Rubber drive / load side			Vul / Vul	Vul / Vul	Vul / Vul	Vul / Vul	Vul / Vul
3.2	Tyre dimensions, drive side		mm	230 x 70	230 x 70	230 x 70	230 x 70	230 x 70
3.3	Tyre dimensions, load side		mm	85 x 99	85 x 90	85 x 90	85 x 75	85 x 75
3.4	Castor wheel dimensions (diameter x width)		mm	140 x 60	125 x 60	125 x 60	125 x 60	125 x 60
3.5	Number of wheels, load / drive side (x = driven)			1 + 1x / 2	1 + 1x / 2	1 + 1x / 2	1 + 1x / 4	1 + 1x / 4
3.6	Track width (center of tyres), drive side	b10	mm	382	517	517	517	517
3.7	Track width (center of tyres), load side	b11	mm	355	385	385	385	385
DIMENSIONS								
4.2b	Height	h1	mm	1400 / 1550	see tables	see tables	see tables	see tables
4.3	Free lift	h2	mm	-	see tables	see tables	see tables	see tables
4.4	Lift height	h3	mm	1700 / 2000	see tables	see tables	see tables	see tables
4.5	Height with mast extended	h4	mm	2145 / 2445	see tables	see tables	see tables	see tables
4.6	Initial lift	h5	mm	-	-	-	-	-
4.9	Height of tiller arm / steering console (min./max.)	h14	mm	913 / 1368	1050 / 1372	1050 / 1372	1050 / 1372	1050 / 1372
4.15	Fork height, fully lowered	h13	mm	90	90	90	90	90
4.19	Overall length	l1	mm	1877	1836	1900 ⁹	1900	1900
4.20	Length to fork face	l2	mm	677	686	750 ⁹	750	750
4.21	Overall width	b1/b2	mm	660	800	800	800	800
4.22	Fork dimensions (thickness, width, length)	s/e/l	mm	65 / 185 / 1200	56 / 186 / 1150	56 / 186 / 1150	56 / 186 / 1150	56 / 186 / 1150
4.24	Fork carriage width	b3	mm		752	752	752	752
4.25	Outside width over forks (minimum / maximum)	b5	mm	540	570	570	570	570
4.26	Inner width of support legs	b4	mm	-	-	-	-	-
4.32	Ground clearance at center of wheelbase, (forks lowered)	m2	mm	25	20	20	20	20
4.33a	Working aisle width (Ast) with 1000 x 1200 mm pallets, load crosswise	Ast	mm	NA				
4.33b	Working aisle width (Ast3) with 1000 x 1200 mm pallets, load crosswise	Ast3	mm	NA				
4.33c	Working aisle width (Ast) with 1000 x 1200 mm pallets, load crosswise, platform up/down	Ast	mm		2291	2355	2355	2355
4.33d	Working aisle width (Ast3) with 1000 x 1200 mm pallets, load crosswise, platform up/down	Ast3	mm		1958	2022	2022	2022
4.34a	Working aisle width (Ast) with 800 x 1200 mm pallets, load lengthwise	Ast	mm	2507				
4.34b	Working aisle width (Ast3) with 800 x 1200 mm pallets, load lengthwise	Ast3	mm	2285				
4.34c	Working aisle width (Ast) with 800 x 1200 mm pallets, load lengthwise, platform up/down	Ast	mm		2283	2347	2347	2347
4.34d	Working aisle width (Ast3) with 800 x 1200 mm pallets, load lengthwise, platform up/down	Ast3	mm		2158	2222	2222	2222
4.35	Turning radius	Wa	mm	1835	1383	1447	1447	1447
PERFORMANCE								
5.1	Travel speed, with / without load		km/h	5.7 / 6	6.0 / 6.0	6.0 / 6.0	6.0 / 6.0	6.0 / 6.0
5.2	Lifting speed, with / without load		m/s	0.10 / 0.20	0.12 / 0.26	0.12 / 0.26	0.12 / 0.26	0.14 / 0.27
5.3	Lowering speed, with / without load		m/s	0.11 / 0.12	0.35 / 0.40	0.35 / 0.40	0.35 / 0.40	0.35 / 0.40
5.7	Gradeability, with / without load		%	7 / 19				
5.8	Maximum gradeability with / without load		%		8 / 15	8 / 15	8 / 15	8 / 15
5.9	Acceleration time (10 metres) with / without load		s	7.60 / 6.76				
5.10	Service brakes (mechanical / hydraulic / electric / pneumatic)			Electric	Electric	Electric	Electric	Electric
ELECTRIC MOTORS								
6.1	Drive motor capacity (60 min. short duty)		kW	1.3	1.0	1.0	1.0	1.0
6.2	Lift motor output at 15% duty factor		kW	2.35	2.2	2.2	2.2	3.2
6.4	Battery voltage/capacity at 5-hour discharge		V/Ah	24 / 150-230	24 / 150	24 / 150-250	24 / 150	24 / 250 - 375
6.5	Battery weight		kg	140 - 215	151	151 - 212	212	212 - 294
6.6a	Energy consumption according to EN16796		kWh/h					
MISCELLANEOUS								
8.1	Type of drive control			Stepless	Stepless	Stepless	Stepless	Stepless
10.7	Level of noise at the ear level of the driver according to EN 12 053:2001 and EN ISO 4871 in work LpAZ		dB(A)	74.6 +/- 0.7				
10.7.1	Level of noise at the ear level of the driver according to EN 12 053:2001 and EN ISO 4871, drive/lift/idle LpAZ		dB(A)		60 / 60 / 41	60 / 60 / 41	60 / 60 / 41	70 / 72 / 41
10.7.2	Whole-body vibration (EN 13 059:2002)				-	-	-	-
10.7.3	Hand-arm vibration (EN 13 059:2002)				< 2.5	< 2.5	< 2.5	< 2.5

Continuing improvement may lead to changes in these specifications

AXIA ES

SBP10 - 16N2 / 12PC Series

PEDESTRIAN AND COMPACT STACKERS

1.0 - 1.6 tonnes



SBP10N2



SBP12PC

VDI - PERFORMANCE & DIMENSIONS

CHARACTERISTICS									
1.1	Manufacturer			Mitsubishi Forklift Trucks	Mitsubishi Forklift Trucks	Mitsubishi Forklift Trucks	Mitsubishi Forklift Trucks	Mitsubishi Forklift Trucks	Mitsubishi Forklift Trucks
1.2	Manufacturer's model designation			SBP12N2(I)	SBP14N2(I)	SBP16N2(I)	SBP12N2R	SBP14N2R	SBP16N2R
1.3	Power source			Electric	Electric	Electric	Electric	Electric	Electric
1.4	Operator type			Pedestrian	Pedestrian	Pedestrian	Pedestrian / Stand-on	Pedestrian / Stand-on	Pedestrian / Stand-on
1.5	Load capacity	Q	kg	1200	1400	1600	1200	1400	1600
1.6	Load center distance	c	mm	600	600	600	600	600	600
1.8	Load wheel axle to fork face (forks lowered)	x	mm	625 (925)	625 (925)	625 (925)	625	925	925
1.9	Wheelbase	y	mm	1205 (1615)	1205 (1615)	1205 (1615)	1205	1615	1615
WEIGHT									
2.1	Truck weight without load, with maximum battery weight		kg	1205 (1350)	1220 (1395)	1225 (1400)	1245	1435	1440
2.2	Axle loadings with nominal load & maximum battery weight, drive / load side		kg	830 (1180) / 1575 (1370)	835 (1240) / 1785 (1555)	835 (1275) / 1990 (1725)	870 / 1575	1280 / 1555	1315 / 1725
2.3	Axle loadings without load & with maximum battery weight, drive / load side		kg	820 (955) / 385 (395)	825 (970) / 395 (425)	825 (970) / 400 (430)	860 / 385	1010 / 425	1010 / 430
WHEELS, DRIVE TRAIN									
3.1	Tyres: PT = Power Thane, Vul = Vulkollan, P = Polyurethane, N = Nylon, R = Rubber drive / load side			Vul / Vul	Vul / Vul	Vul / Vul	Vul / Vul	Vul / Vul	Vul / Vul
3.2	Tyre dimensions, drive side		mm	230 × 70	230 × 70	230 × 70	230 × 70	230 × 70	230 × 70
3.3	Tyre dimensions, load side		mm	85 × 90	85 × 75	85 × 75	85 × 90	85 × 75	85 × 75
3.4	Castor wheel dimensions (diameter x width)		mm	125 × 60	125 × 60	125 × 60	125 × 60	125 × 60	125 × 60
3.5	Number of wheels, load / drive side (x = driven)			1 + 1x / 2	1 + 1x / 4	1 + 1x / 4	1 + 1x / 2	1 + 1x / 4	1 + 1x / 4
3.6	Track width (center of tyres), drive side	b10	mm	517	517	517	517	517	517
3.7	Track width (center of tyres), load side	b11	mm	385	385	385	385	385	385
DIMENSIONS									
4.2b	Height	h1	mm	see tables	see tables	see tables	see tables	see tables	see tables
4.3	Free lift	h2	mm	see tables	see tables	see tables	see tables	see tables	see tables
4.4	Lift height	h3	mm	see tables	see tables	see tables	see tables	see tables	see tables
4.5	Height with mast extended	h4	mm	see tables	see tables	see tables	see tables	see tables	see tables
4.6	Initial lift	h5	mm	- (115)	- (115)	- (115)	115	115	115
4.9	Height of tiller arm / steering console (min./max.)	h14	mm	1050 / 1372	1050 / 1372	1050 / 1372	1150 / 1350	1150 / 1350	1150 / 1350
4.15	Fork height, fully lowered	h13	mm	90	90	90	90	90	90
4.19	Overall length	l1	mm	1900 (2007)	1900 (2007)	1900 (2007)	2127 / 2607	2127 / 2607	2127 / 2607
4.20	Length to fork face	l2	mm	750 (857)	750 (857)	750 (857)	977 / 1457	977 / 1457	977 / 1457
4.21	Overall width	b1/b2	mm	800	800	800	800	800	800
4.22	Fork dimensions (thickness, width, length)	s/e/l	mm	56 / 186 / 1150	56 / 186 / 1150	56 / 186 / 1150	56 / 186 / 1150	56 / 186 / 1150	56 / 186 / 1150
4.24	Fork carriage width	b3	mm	752	752	752	752	752	752
4.25	Outside width over forks (minimum / maximum)	b5	mm	570	570	570	570	570	570
4.26	Inner width of support legs	b4	mm	-	-	-	-	-	-
4.32	Ground clearance at center of wheelbase, (forks lowered)	m2	mm	20	20	20	20	20	20
4.33a	Working aisle width (Ast) with 1000 x 1200 mm pallets, load crosswise	Ast	mm						
4.33b	Working aisle width (Ast3) with 1000 x 1200 mm pallets, load crosswise	Ast3	mm						
4.33c	Working aisle width (Ast) with 1000 x 1200 mm pallets, load crosswise, platform up/down	Ast	mm	2355 (2653)	2355 (2653)	2355 (2653)	2773 / 3253	2773 / 3253	2773 / 3253
4.33d	Working aisle width (Ast3) with 1000 x 1200 mm pallets, load crosswise, platform up/down	Ast3	mm	2022 (2123)	2022 (2123)	2022 (2123)	2243 / 2723	2243 / 2723	2243 / 2723
4.34a	Working aisle width (Ast) with 800 x 1200 mm pallets, load lengthwise	Ast	mm						
4.34b	Working aisle width (Ast3) with 800 x 1200 mm pallets, load lengthwise	Ast3	mm						
4.34c	Working aisle width (Ast) with 800 x 1200 mm pallets, load lengthwise, platform up/down	Ast	mm	2347 (2533)	2347 (2533)	2347 (2533)	2653 / 3133	2653 / 3133	2653 / 3133
4.34d	Working aisle width (Ast3) with 800 x 1200 mm pallets, load lengthwise, platform up/down	Ast3	mm	2222 (2323)	2222 (2323)	2222 (2323)	2443 / 2923	2443 / 2923	2443 / 2923
4.35	Turning radius	Wa	mm	1447 (1848)	1447 (1848)	1447 (1848)	1968 / 2448	1968 / 2448	1968 / 2448
PERFORMANCE									
5.1	Travel speed, with / without load		km/h	6.0 / 6.0	6.0 / 6.0	6.0 / 6.0	6.0 / 6.0	6.0 / 6.0	6.0 / 6.0
5.2	Lifting speed, with / without load		m/s	0.12 / 0.26	0.12 / 0.26	0.14 / 0.27	0.12 / 0.26	0.12 / 0.26	0.14 / 0.27
5.3	Lowering speed, with / without load		m/s	0.35 / 0.40	0.35 / 0.40	0.35 / 0.40	0.35 / 0.40	0.35 / 0.40	0.35 / 0.40
5.7	Gradeability, with / without load		%						
5.8	Maximum gradeability with / without load		%	8 / 15	8 / 15	8 / 15	8 / 15	8 / 15	8 / 15
5.9	Acceleration time (10 metres) with / without load		s						
5.10	Service brakes (mechanical / hydraulic / electric / pneumatic)			Electric	Electric	Electric	Electric	Electric	Electric
ELECTRIC MOTORS									
6.1	Drive motor capacity (60 min. short duty)		kW	1.0	1.0	1.0	1.0	1.0	1.0
6.2	Lift motor output at 15% duty factor		kW	2.2	2.2	3.2	2.2	2.2	3.2
6.4	Battery voltage/capacity at 5-hour discharge		V/Ah	24 / 150-250	24 / 250	24 / 250-375	24 / 150 - 250	24 / 250	24 / 250-375
6.5	Battery weight		kg	151 - 212	212	212-294	151 - 212	212	212-294
6.6a	Energy consumption according to EN16796		kWh/h						
MISCELLANEOUS									
8.1	Type of drive control			Stepless	Stepless	Stepless	Stepless	Stepless	Stepless
10.7	Level of noise at the ear level of the driver according to EN 12 053:2001 and EN ISO 4871 in work LpAZ		dB(A)						
10.7.1	Level of noise at the ear level of the driver according to EN 12 053:2001 and EN ISO 4871, drive/lift/idle LpAZ		dB(A)	60 / 60 / 41	60 / 60 / 41	70 / 72 / 41	60 / 60 / 41	60 / 60 / 41	70 / 72 / 41
10.7.2	Whole-body vibration (EN 13 059:2002)			-	-	-	0.8	0.8	0.8
10.7.3	Hand-arm vibration (EN 13 059:2002)			< 2.5	< 2.5	< 2.5	< 2.5	< 2.5	< 2.5

Continuing improvement may lead to changes in these specifications

VDI - PERFORMANCE & DIMENSIONS

CHARACTERISTICS				Mitsubishi Forklift Trucks	Mitsubishi Forklift Trucks	Mitsubishi Forklift Trucks	Mitsubishi Forklift Trucks	Mitsubishi Forklift Trucks
1.1	Manufacturer			SBP12N2(I)R	SBP14N2(I)R	SBP16N2(I)R	SBP16N2S	SBP16N2SR
1.2	Manufacturer's model designation			Electric	Electric	Electric	Electric	Electric
1.3	Power source			Pedestrian	Pedestrian	Pedestrian	Pedestrian	Pedestrian
1.4	Operator type			1200	1400	1600	1600	1600
1.5	Load capacity	Q	kg	600	600	600	600	600
1.6	Load center distance	c	mm	625 (925)	625 (925)	625 (925)	650	650
1.8	Load wheel axle to fork face (forks lowered)	x	mm	1205 (1615)	1205 (1615)	1205 (1615)	1295	1295
1.9	Wheelbase	y	mm					
WEIGHT								
2.1	Truck weight without load, with maximum battery weight		kg	1245 (1390)	1260 (1435)	1265 (1440)	1397	1437
2.2	Axle loadings with nominal load & maximum battery weight, drive / load side		kg	870 (1220) / 1575 (1370)	875 (1280) / 1785 (1555)	875 (1315) / 1990 (1725)	1941 / 1056	1981 / 1056
2.3	Axle loadings without load & with maximum battery weight, drive / load side		kg	860 (995) / 385 (395)	865 (1010) / 395 (425)	865 (1010) / 400 (430)	945 / 452	985 / 452
WHEELS, DRIVE TRAIN								
3.1	Tyres: PT = Power Thane, Vul = Vulkollan, P = Polyurethane, N = Nylon, R = Rubber drive / load side			Vul / Vul	Vul / Vul	Vul / Vul	Vul / Vul	Vul / Vul
3.2	Tyre dimensions, drive side		mm	230 x 70	230 x 70	230 x 70	230 x 70	230 x 70
3.3	Tyre dimensions, load side		mm	85 x 90	85 x 75	85 x 75	85 x 75	85 x 75
3.4	Castor wheel dimensions (diameter x width)		mm	125 x 60	125 x 60	125 x 60	125 x 60	125 x 60
3.5	Number of wheels, load / drive side (x = driven)			1 + 1x / 2	1 + 1x / 4	1 + 1x / 4	1 + 1x / 4	1 + 1x / 4
3.6	Track width (center of tyres), drive side	b10	mm	517	517	517	517	517
3.7	Track width (center of tyres), load side	b11	mm	385	385	385	1025-1425	1025-1425
DIMENSIONS								
4.2b	Height	h1	mm	see tables	see tables	see tables	see tables	see tables
4.3	Free lift	h2	mm	see tables	see tables	see tables	see tables	see tables
4.4	Lift height	h3	mm	see tables	see tables	see tables	see tables	see tables
4.5	Height with mast extended	h4	mm	see tables	see tables	see tables	see tables	see tables
4.6	Initial lift	h5	mm	- (115)	- (115)	- (115)	-	-
4.9	Height of tiller arm / steering console (min./max.)	h14	mm	1150 / 1350	1150 / 1350	1150 / 1350	1150/1350	1150 / 1350
4.15	Fork height, fully lowered	h13	mm	90	90	90	85	85
4.19	Overall length	l1	mm	2020 (2127) / 2500 (2607)	2020 (2127) / 2500 (2607)	2020 (2127) / 2500 (2607)	1967	2087 / 2567
4.20	Length to fork face	l2	mm	870(977)/1350(1457)	870(977)/1350(1457)	870(977)/1350(1457)	817	937 / 1417
4.21	Overall width	b1/b2	mm	800	800	800	800 / 1140-1575	800 / 1140-1575
4.22	Fork dimensions (thickness, width, length)	s/e/l	mm	56 / 186 / 1150	56 / 186 / 1150	56 / 186 / 1150	40 / 100 / 1150	40 / 100 / 1150
4.24	Fork carriage width	b3	mm	752	752	752	980	980
4.25	Outside width over forks (minimum / maximum)	b5	mm	570	570	570	260-900	260-900
4.26	Inner width of support legs	b4	mm	-	-	-	900-1300	900-1300
4.32	Ground clearance at center of wheelbase, (forks lowered)	m2	mm	20	20	20	20	20
4.33a	Working aisle width (Ast) with 1000 x 1200 mm pallets, load crosswise	Ast	mm					
4.33b	Working aisle width (Ast3) with 1000 x 1200 mm pallets, load crosswise	Ast3	mm					
4.33c	Working aisle width (Ast) with 1000 x 1200 mm pallets, load crosswise, platform up/down	Ast	mm	2475 (2773) / 2955 (3253)	2475 (2773) / 2955 (3253)	2475 (2773) / 2955 (3253)	2430	2550 / 3030
4.33d	Working aisle width (Ast3) with 1000 x 1200 mm pallets, load crosswise, platform up/down	Ast3	mm	2142 (2243) / 2622 (2723)	2142 (2243) / 2622 (2723)	2142 (2243) / 2622 (2723)	2085	2205 / 2685
4.34a	Working aisle width (Ast) with 800 x 1200 mm pallets, load lengthwise	Ast	mm					
4.34b	Working aisle width (Ast3) with 800 x 1200 mm pallets, load lengthwise	Ast3	mm					
4.34c	Working aisle width (Ast) with 800 x 1200 mm pallets, load lengthwise, platform up/down	Ast	mm	2467 (2653) / 2947 (3133)	2467 (2653) / 2947 (3133)	2467 (2653) / 2947 (3133)	2415	2535 / 3015
4.34d	Working aisle width (Ast3) with 800 x 1200 mm pallets, load lengthwise, platform up/down	Ast3	mm	2342 (2443) / 2822 (2923)	2342 (2443) / 2822 (2923)	2342 (2443) / 2822 (2923)	2285	2405 / 2885
4.35	Turning radius	Wa	mm	1567 (1968) / 2047 (2448)	1567 (1968) / 2047 (2448)	1567 (1968) / 2047 (2448)	1535	1655 / 2135
PERFORMANCE								
5.1	Travel speed, with / without load		km/h	6.0 / 6.0	6.0 / 6.0	6.0 / 6.0	6.0 / 6.0	6.0 / 6.0
5.2	Lifting speed, with / without load		m/s	0.12 / 0.26	0.12 / 0.26	0.14 / 0.27	0.14 / 0.27	0.14 / 0.27
5.3	Lowering speed, with / without load		m/s	0.35 / 0.40	0.35 / 0.40	0.35 / 0.40	0.35 / 0.40	0.35 / 0.40
5.7	Gradeability, with / without load		%	8 / 15	8 / 15	8 / 15	8 / 15	8 / 15
5.8	Maximum gradeability with / without load		%					
5.9	Acceleration time (10 metres) with / without load		s					
5.10	Service brakes (mechanical / hydraulic / electric / pneumatic)			Electric	Electric	Electric	Electric	Electric
ELECTRIC MOTORS								
6.1	Drive motor capacity (60 min. short duty)		kW	1.0	1.0	1.0	1.0	1.0
6.2	Lift motor output at 15% duty factor		kW	2.2	2.2	3.2	3.2	3.2
6.4	Battery voltage/capacity at 5-hour discharge		V/Ah	24 / 150-250	24 / 250	24 / 250-375	24 / 250-375	24 / 250-375
6.5	Battery weight		kg	151-212	212	212-294	212-294	212-294
6.6a	Energy consumption according to EN16796		kWh/h					
MISCELLANEOUS								
8.1	Type of drive control			Stepless	Stepless	Stepless	Stepless	Stepless
10.7	Level of noise at the ear level of the driver according to EN 12 053:2001 and EN ISO 4871 in work LpAZ		dB(A)					
10.7.1	Level of noise at the ear level of the driver according to EN 12 053:2001 and EN ISO 4871, drive/lift/idle LpAZ		dB(A)	60 / 60 / 41	60 / 60 / 41	70 / 72 / 41	70 / 72 / 41	70 / 72 / 41
10.7.2	Whole-body vibration (EN 13 059:2002)			0.8	0.8	0.8	-	0.8
10.7.3	Hand-arm vibration (EN 13 059:2002)			< 2.5	< 2.5	< 2.5	< 2.5	< 2.5

Continuing improvement may lead to changes in these specifications

AXIA ES

SBP10 - 16N2 / 12PC Series

PEDESTRIAN STACKERS

1.0 - 1.6 tonnes



SBP16N2SR

MAST PERFORMANCE AND CAPACITY

AXIA ES

SBP10-16N2(I)(S)(R) / 12PC Series

PEDESTRIAN STACKERS

1.0 – 1.6 tonnes

MAST TYPE	h3 + h13 mm	h1 mm	h4 mm	h2 + h13 mm
SBP10N2				
SIMPLEX	1500	1980	1980	1500
DUPLEX	2500	1775	3000	195
	2900	1975	3400	195
	3300	2175	3800	195
SBP12PC				
DUPLEX	1790	1400*		NA
	2090	1550*		NA
SBP12/14/16N2 / SBP12/14/16N2R				
SIMPLEX	1500	1950	1950	1500
DUPLEX	2500	1835	3000	200
	2900	2035	3400	200
	3300	2235	3800	200
	3600	2385	4100	200
	4300	2735	4800	200
DUPLEX FREE-LIFT	2500	1775	2940	1355
	2900	1975	3340	1555
	3300	2235	3800	1755
	3600	2385	4100	1905
	4300	2735	4800	2255
TRIPLEX	4100	1955	4640	
	4300	2020	4840	
	4700	2153	5240	
	5400**	2385	5940	
TRIPLEX FREE-LIFT	4100	1955	4640	1475
	4300	2020	4840	1540
	4700	2153	5240	1673
	5400**	2385	5940	1905

MAST TYPE	h3 + h13 mm	h1 mm	h4 mm	h2 + h13 mm
SBP12/14/16N2I / SBP12/14/16N2IR				
SIMPLEX	1500	2055	2055	1505
DUPLEX	2500	1940	3105	200
	2900	2140	3505	200
	3300	2340	3905	200
	3600	2490	4205	200
	4300	2840	4905	200
DUPLEX FREE-LIFT	2500	1940	3105	1360
	2900	2140	3505	1560
	3300	2340	3905	1760
	3600	2490	4205	1910
	4300	2840	4905	2260
TRIPLEX	4100	2060	4745	
	4300	2125	4945	
	4700	2260	5345	
	5400**	2490	6045	
	4100	2060	4745	1480
TRIPLEX FREE-LIFT	4300	2125	4945	1545
	4700	2260	5345	1673
	5400**	2490	6045	1910
SBP16N2S / SBP16N2SR				
SIMPLEX	1500	2030	2030	1500
DUPLEX	2500	1915	3080	195
	2900	2115	3480	195
	3300	2315	3880	195
	3600	2465	4180	195
	4300	2815	4880	195
DUPLEX FREE-LIFT	2500	1915	3080	1355
	2900	2115	3480	1555
	3300	2315	3880	1755
	3600	2465	4180	1905
	4300	2815	4880	2255
TRIPLEX	4100	2035	4720	
	4300	2100	4920	
	4700	2233	5320	
	5400	2465	6020	
	4100	2035	4720	1475
TRIPLEX FREE-LIFT	4300	2100	4920	1540
	4700	2233	5320	1753
	5400	2465	6020	1905

* h1 closed mast height includes poly carbonate finger protection. Mast height excl. Finger protection is 1343mm / 1493mm.

** Only SBP14N2-16N2 & SBP14N2I-16N2I

S = Simplex
DS = Duplex with clear-view mast
DEV = Duplex with full free lift
TR = Triplex with clear-view mast
TREV = Triplex with full free lift
h3+h13 = Lifting height
h1 = Lowered mast height
h4 = Raised mast height
h2+h13 = Free lift

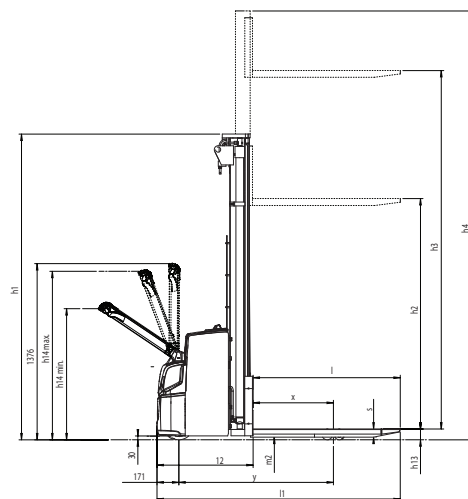

Ast = Working aisle width
Ast3 = Working aisle width (b12 < 1000 mm)
 $Ast = Wa + \sqrt{(l6 - x)^2 + (b12/2)^2} + a$
Ast3 = $Wa + l6 - x + a$

Wa = Turning radius
l6 = Pallet length
x = Load wheel axle to fork face
b12 = Pallet width
a = Safety clearance = 2 x 100 mm

SBP10 / 12 / 14 / 16N2

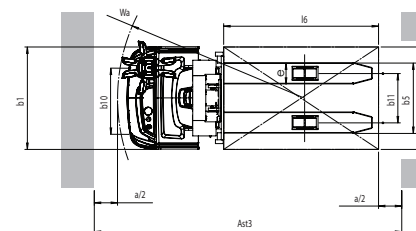

SBP12PC

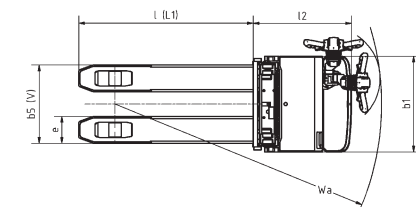

SBP12 / 14 / 16N2I

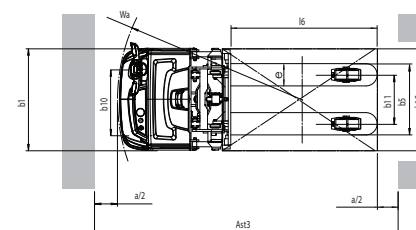

MAST PERFORMANCE AND CAPACITY

AXIA ES

SBP10-16N2/12PC Series

PEDESTRIAN STACKERS

1.0 – 1.6 tonnes

Ast = Working aisle width
Ast3 = Working aisle width (b12 < 1000 mm)
 $Ast = Wa + \sqrt{(l6 - x)^2 + (b12/2)^2} + a$
Ast3 = Wa + l6 - x + a

Wa = Turning radius
l6 = Pallet length
x = Load wheel axle to fork face
b12 = Pallet width
a = Safety clearance = 2 x 100 mm

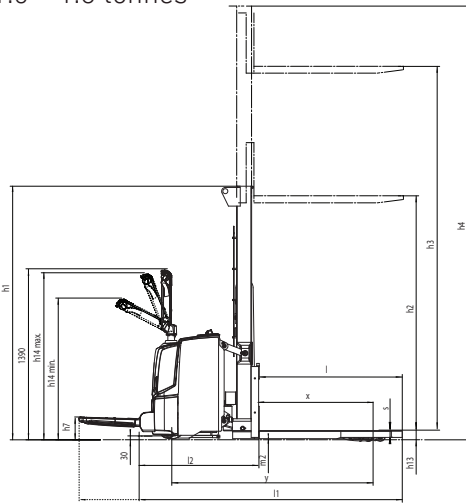

**SBP12 / 14 / 16N2(I)R
WITH FOLDING PLATFORM**

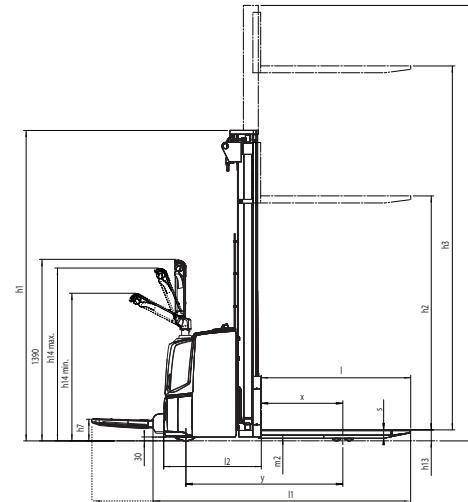
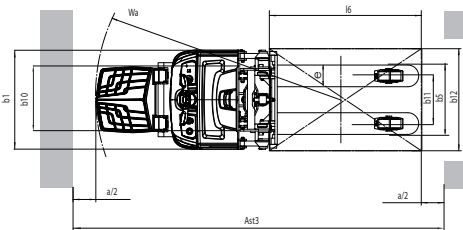

**SBP12 / 14 / 16N2R
WITH FOLDING PLATFORM**

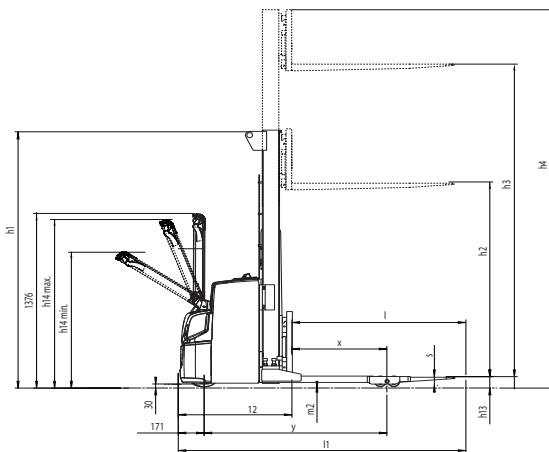
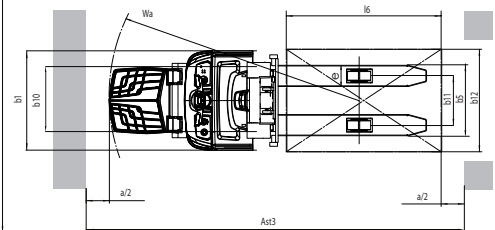

SBP16N2S

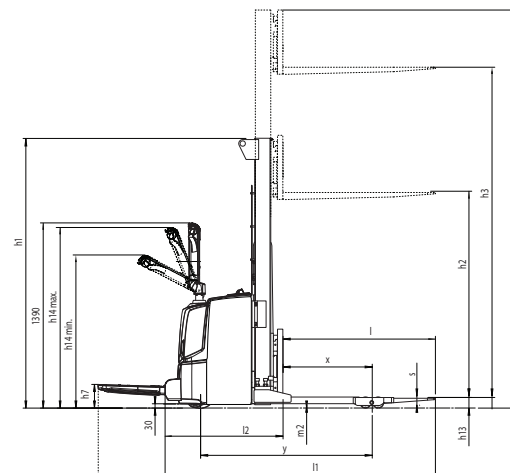
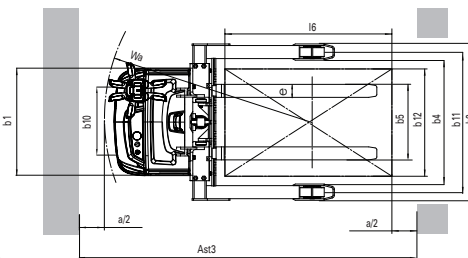

**SBP16N2SR
WITH FOLDING PLATFORM**

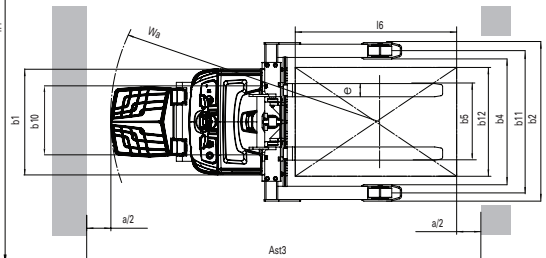

STANDARD EQUIPMENT & OPTIONS

- = Standard
- = Standard on initial lift models only
- = Option

	SBP10N2	SBP12PC	SBP12N2(I)	SBP14N2(I)	SBP16N2(I)	SBP12N2(I)R	SBP14N2(I)R	SBP16N2(I)R	SBP16N2S	SBP16N2SR
GENERAL										
LED discharge indicator, no hour meter	●		●	●	●	●	●	●	●	●
Multifunctional display, including hour meter	●		●	●	●	●	●	●	●	●
Micro-computer incl. hour meter and battery indicator with cutout (ATC T4)		●								
PIN code login 100 codes		●								
PIN code login 4 codes	●		●	●	●	●	●	●	●	●
Offset tiller arm with display and keypad		●								
Chill store design, down to 1°C, with rust-protected axles		●								
Proportional valve for lifting and lowering, controlled by fingertip lever on tiller head	●		●	●	●	●	●	●	●	●
Electric on/off valve for lifting and lowering, controlled by rocker switch on tiller head		●								
Polyurethane drive wheel	●	●	●	●	●	●	●	●	●	●
Polyurethane drive wheel or rubber		●								
Initial lift			●●	●●	●●	●●	●●	●●		
Single load wheels polyurethane	●	●	●							
Tandem load wheels polyurethane	●	●	●	●	●	●	●	●	●	●
Adjustable width between straddle load legs; 900mm - 1300mm									●	●
Sideways battery change (250Ah battery only)			●	●	●	●	●	●	●	●
Li-ion batteries		●								
ENVIRONMENT										
Cold store design, 0°C to -35°C	●	●	●	●	●	●	●	●	●	●
DRIVE AND LIFT CONTROLS										
Heavy duty tiller head - with key switch entry		●								
Tiller in line with chassis contour		●								
Tiller up drive	●	●	●	●	●	●	●	●	●	●
WHEEL OPTIONS										
Polyurethane traction and load wheels	●	●	●	●	●	●	●	●	●	●
Power friction traction wheel	●	●	●	●	●	●	●	●	●	●
Non-marking drive wheel		●								
Anti-static drive wheel		●								
OTHER OPTIONS										
Speed reduction 0,5km/h above 1000mm lift, duplex and triplex masts without free lift			●	●	●	●	●	●	●	●
Speed reduction 0,5km/h above free lift, duplex and triplex masts with free lift			●	●	●	●	●	●	●	●
Inbuilt charger, 30A	●		●	●	●	●	●	●	●	●
Rubber foot protection										
Diselectric band		●								
Key switch	●	●	●	●	●	●	●	●	●	●
Piezo buzzer instead of standard horn		●								
Special RAL colour	●	●	●	●	●	●	●	●	●	●
Load backrest	●	●	●	●	●	●	●	●	●	●
Accessory rack	●	●	●	●	●	●	●	●	●	●
List bracket, A4 size	●	●	●	●	●	●	●	●	●	●

*Only available on SBP12PC. ***Not available on SBP12PC.

AXIA ES

SBP10-16N2/12PC Series

PEDESTRIAN STACKERS

1.0 – 1.6 tonnes



Rubber foot protection



Sealed inbuilt charger



Equipment bar for mounting accessories (on most models)

WHEN RELIABILITY IS EVERYTHING...



AXIA
THE ALL ROUNDER

With a name that reflects its manoeuvrability, AXIA combines award-winning ergonomics with high performance and low maintenance features to deliver a complete warehouse support package.

Efficient, versatile and durable, AXIA is the perfect choice for every workplace.

Like any product bearing the "MITSUBISHI" name our materials handling equipment benefits from the tremendous heritage, huge resources and cutting-edge technology of one of the world's largest corporations – Mitsubishi Heavy Industries Group.

Engineering spacecraft, jet planes, power plants and more, MHI specialises in those technologies where performance, dependability and superiority decide your success or failure...

So when we promise you quality, reliability and value for money, you know it's a guarantee we have the power to deliver.

That's why every model in our award-winning and comprehensive range of lift trucks and warehouse equipment is built to a high specification – to ensure it keeps working for you. Day after day. Year after year. Whatever the job. Whatever the conditions.

YOU'LL NEVER WORK ALONE

As your local authorised dealer, we are here to keep your trucks working – through our extensive experience, our technical excellence and our commitment to customer care.

We are your local experts, backed by efficient channels to the entire organisation of Mitsubishi Forklift Trucks.

No matter where you are, we are close by – with the capability to meet your needs.

Discover how Mitsubishi Forklift Trucks give you more from your local authorised dealer or when you visit our website www.mitforklift.com

Performance specifications may vary depending on standard manufacturing tolerances, vehicle condition, types of tyres, floor or surface conditions, applications or operating environment. Trucks may be shown with non-standard options. Specific performance requirements and locally available configurations should be discussed with your distributor of Mitsubishi forklift trucks. We follow a policy of continual product improvement. For this reason, some materials, options and specifications could change without notice.

info@mitforklift.com

WESM1989 (10/19) © 2020 MLE



Mitsubishi Logisnext Europe B.V.
Hefbrugweg 77, 1332 AM Almere
The Netherlands
Tel: +31 (0)36 5494 411



mft2.eu/fb



mft2.eu/apps



mft2.eu/youtube



mft2.eu/facebook

